

NOTES
 For all paving, landscaping, fencing, retaining wall detail, location and sizes, refer to Future Landscape Plans to be submitted as a Condition of Consent.
 Permeability – Final Detail will be provided on Future Landscape Plan, however a minimum of 20% of the site will be impervious.
 House Floor Levels indicate Maximum Height.

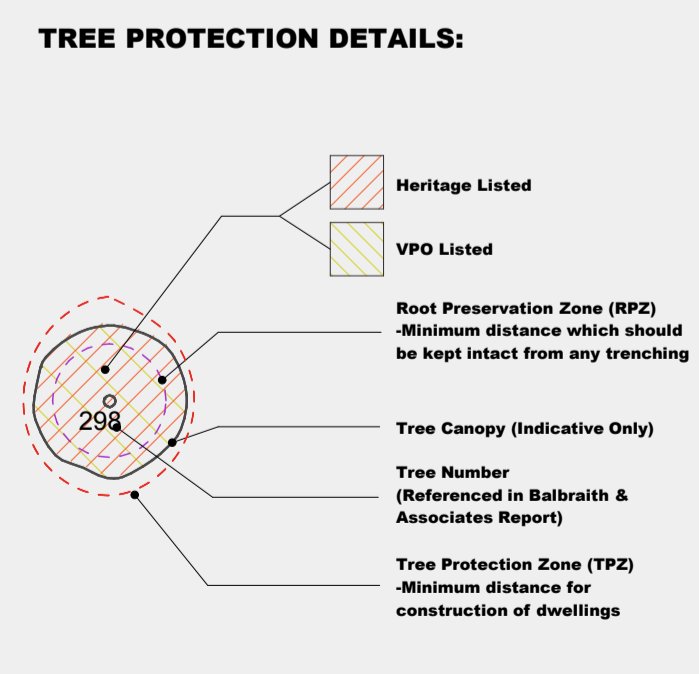
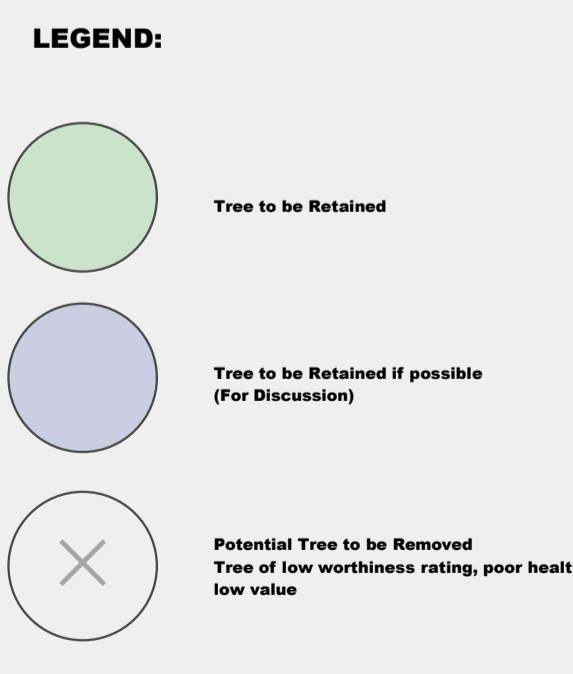
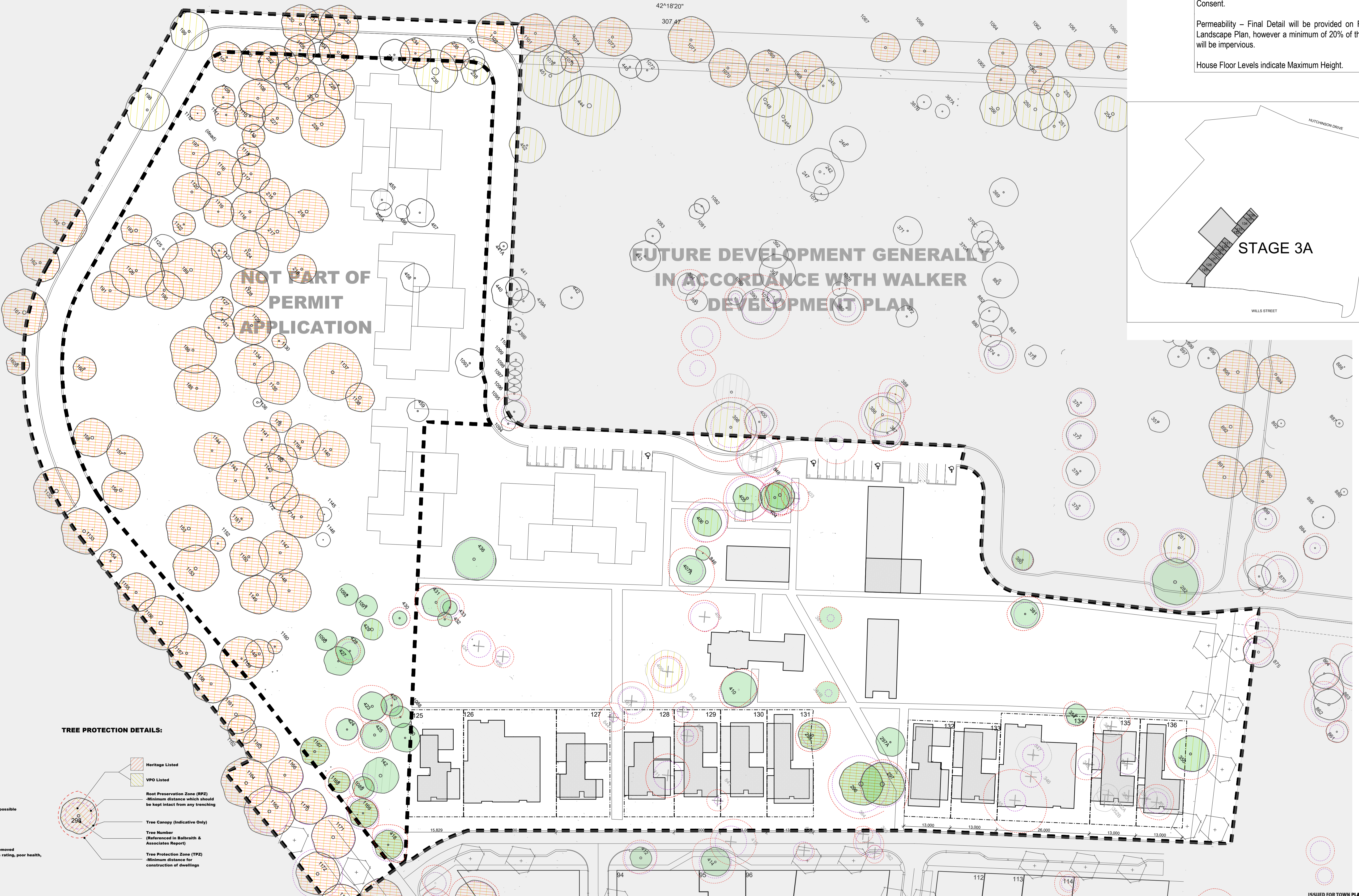
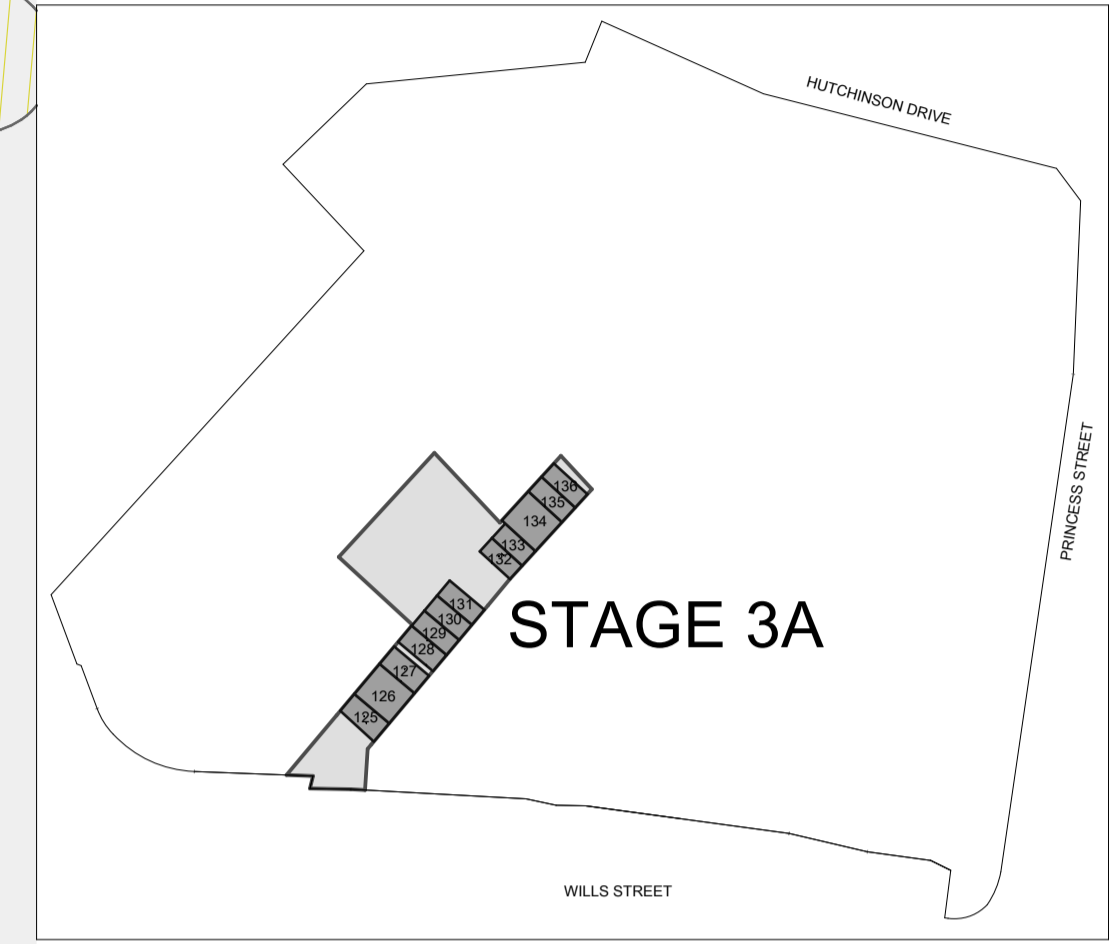

Rev	Description	By	Date	Client Details
3	TOWN PLANNING ISSUE	NR	10/02/2010	Walker Corporation

Project	KEW STAGE 3A HOUSING	Drawing	Stage 3a Town Planning
Project Location	KEW MELBOURNE VIC, 3184	Project Name	Stage 3a Tree Protection Plan
Project Number	00010409	Scale	1:500 @ A4
		Drawn	RM Checked
		Drawing Number	AR03A.21.05

dko
 © dko Architecture Pty Ltd
 Except as allowed under copyright act, no part of this drawing may be reproduced or otherwise dealt with without written permission of dko Architecture.
 Architect
 dko architecture (Victoria) pty ltd
 Level 2, 358 Lonsdale Street
 Melbourne, Victoria, 3000, AUS
 T +61 3 9670 3088 / F +61 3 9670 3054
 www.dko.com.au / info@dko.com.au
 ABN: 61 431 781 616

ISSUED FOR TOWN PLANNING